

360nm LED 5mm Hard Lens YL-5MM(15)-360nM(0.5mW)

FEATURES AND APPLICATIONS

- Deep UV wavelength, highly consistent
- HVPE epitaxy process, patent protected, unique in the industry
- UV lamps for industrial curing applications and medical/biomedical uses

SPECIFICATIONS

Absolute Maximum Rating (Ta = 25°C)

| Item | Symbol | Maximum Rating | Unit |
|------------------------|-----------|----------------|------|
| DC Forward Current | I_f | 30 | mA |
| Pulse Forward Current* | I_{fp} | 80 | mA |
| Reverse Voltage | V_r | 5 | V |
| Operating Temperature | T_{opr} | -20 to +80 | °C |
| Storage Temperature | T_{stg} | -40 to +100 | °C |

*Condition: Duty Cycle: 1/10, Pulse Width: 10msec

Optical and Electrical Characteristics (Ta = 25°C)

| Item | Symbol | Condition | Min | Typ. | Max | unit |
|-------------------|-------------|------------|-----|------|------|------|
| Forward Voltage | V_f | $I_f=20mA$ | 3.6 | 4.3 | 5.0 | V |
| Reverse Current | I_r | $V_r=5V$ | - | - | 100 | uA |
| Peak Wavelength | λ_p | $I_f=20mA$ | 360 | 361 | 363 | nm |
| Viewing Angle* | | $I_f=20mA$ | - | 10 | - | deg. |
| Output Power/Flux | P_o | $I_f=20mA$ | 300 | 500 | 1200 | uW |

Lamp Description (typical)

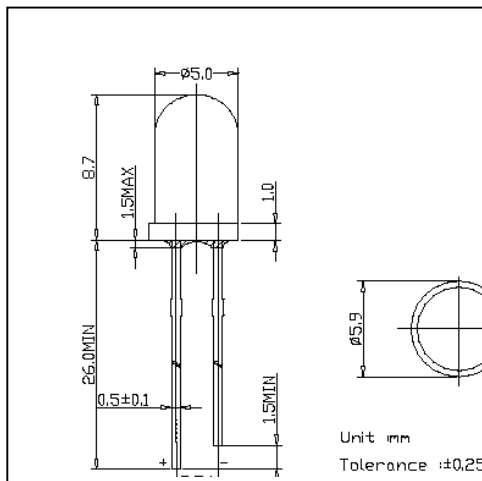

- Hard polymer lens, 5 mm (T-1 3/4 package), UV resistant
- Water clear
- 15 degree viewing angle

Typical Spectrum

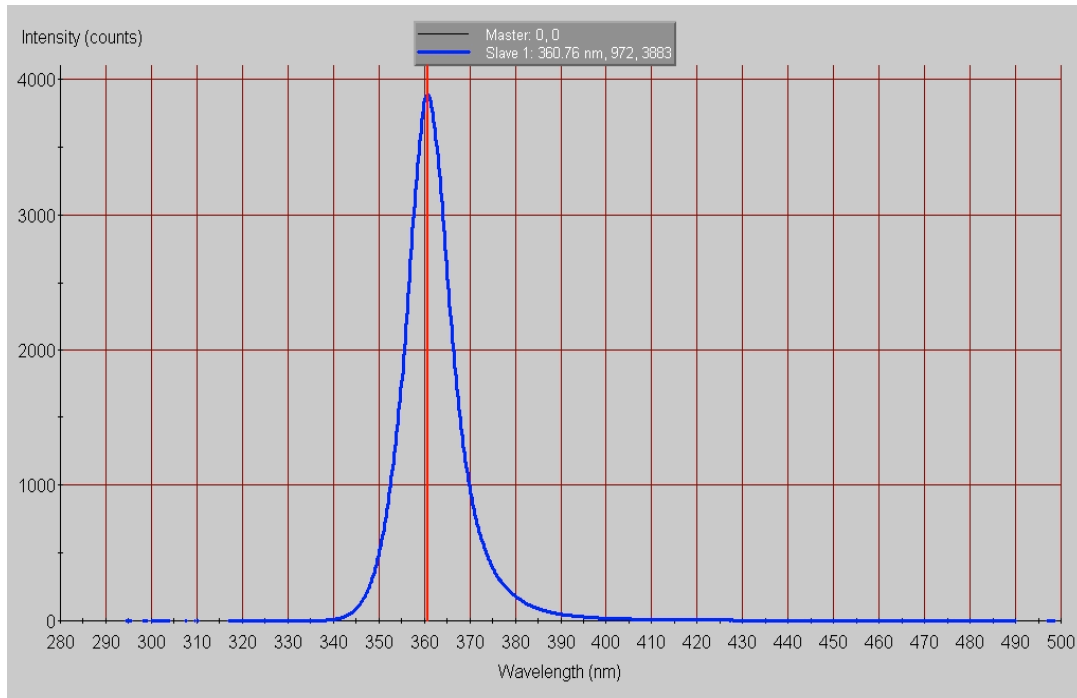

Warnings and Handling Instructions

- **UV LEDs emit intense but mainly invisible ultraviolet radiation when in operation, which may be harmful to eyes, even for brief periods.**
- *** DO NOT LOOK DIRECTLY INTO THE UV LED DURING OPERATION ***
- *** BE SURE THAT YOU AND ALL PERSONS IN THE VICINITY WEAR SAFETY GOGGLES THAT PROVIDE SUITABLE UV PROTECTION WHEN A UV LED IS OPERATING ***
- *** KEEP CHILDREN AWAY FROM THE OPERATING VICINITY ***
- *** KEEP UV LEDs OUT OF THE REACH OF CHILDREN ***
- **If you incorporate a UV LED into a product, be sure to provide appropriate cautionary labels and instructions.**
- **Please follow all standard procedures for storing, handling, cleaning, mounting, soldering, disposal, or otherwise handling LED dies or packaged LEDs, including static electricity protection.**

Typical Electrical and Optical Characteristics Curves

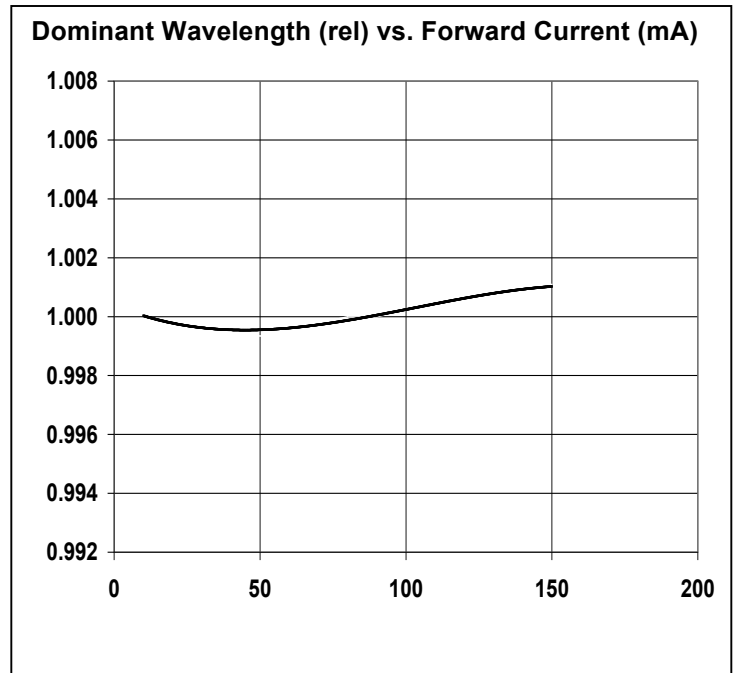
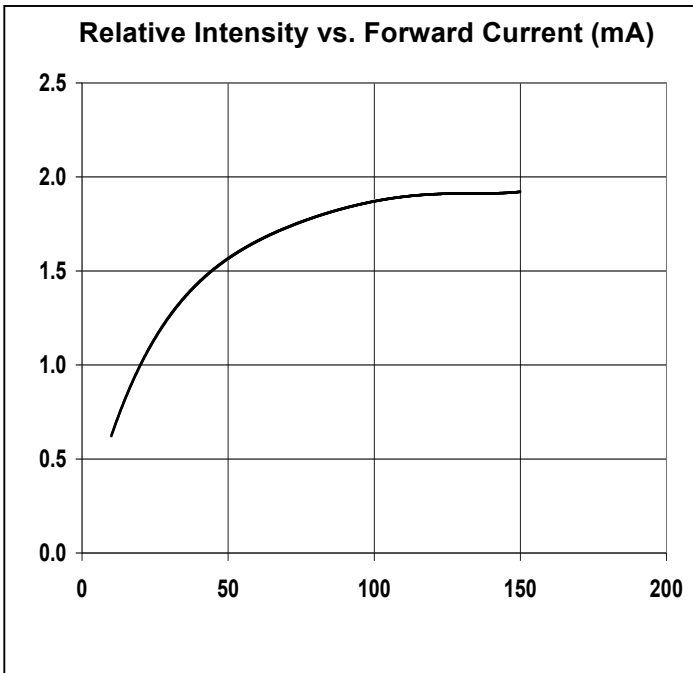
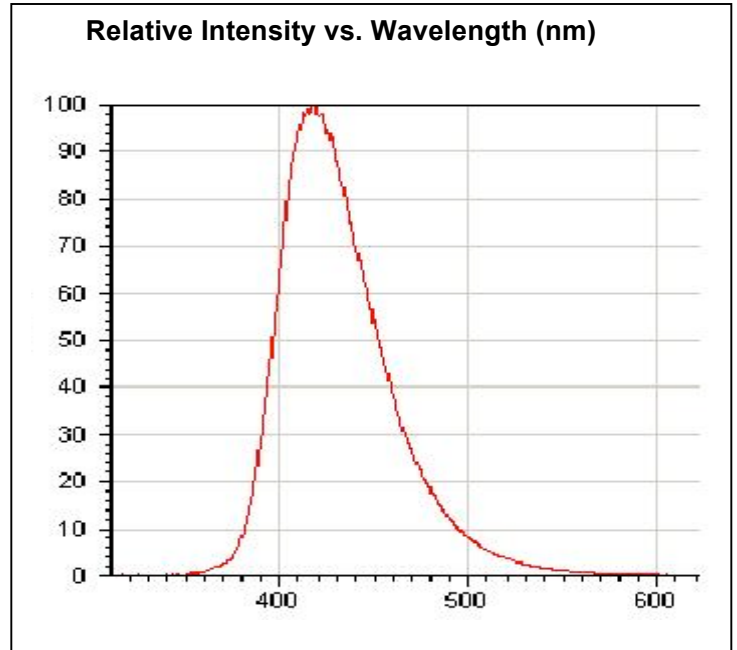
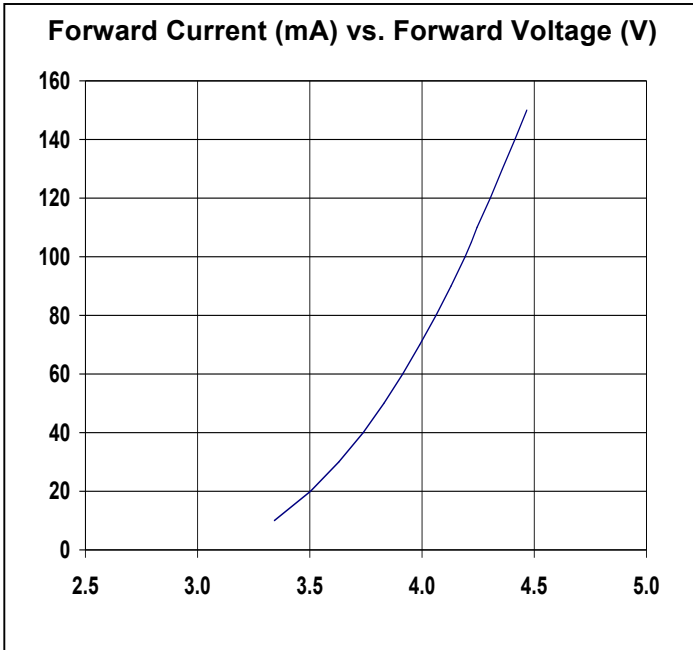

These are typical measurements, representative of specific production lots; actual curves may vary.

Typical Electrical and Optical Characteristics Curves

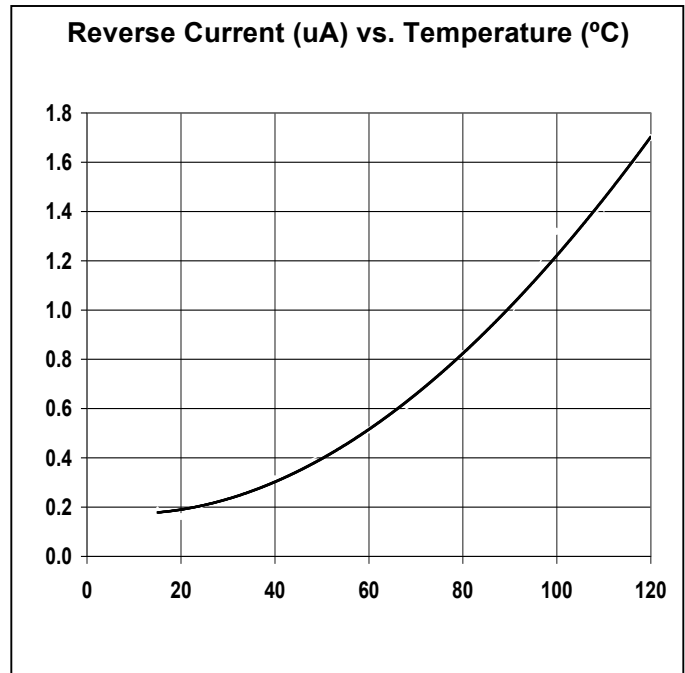
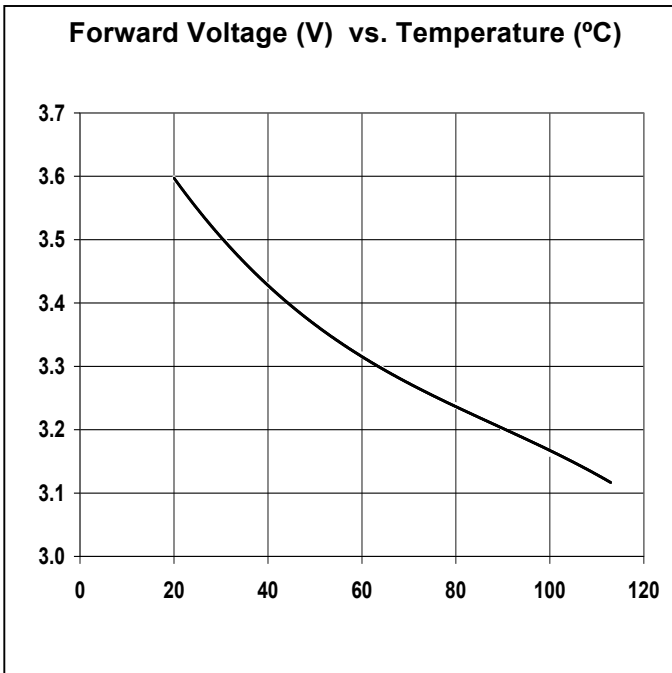
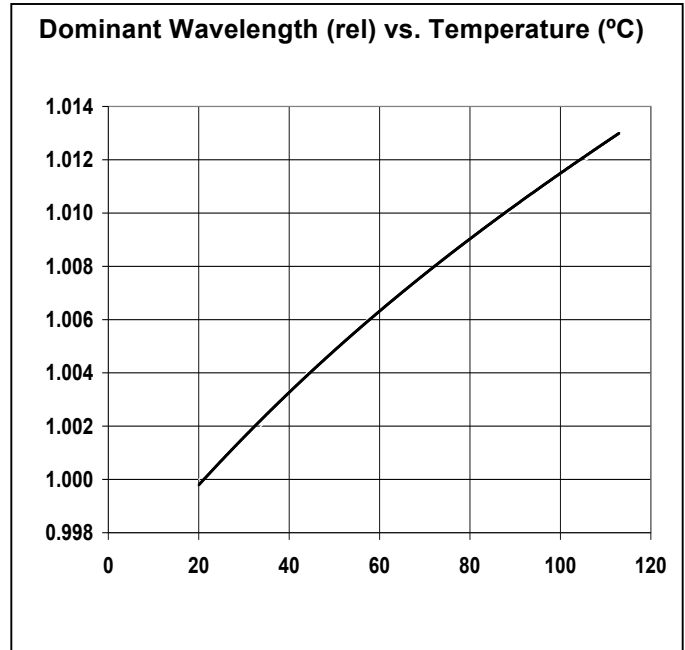
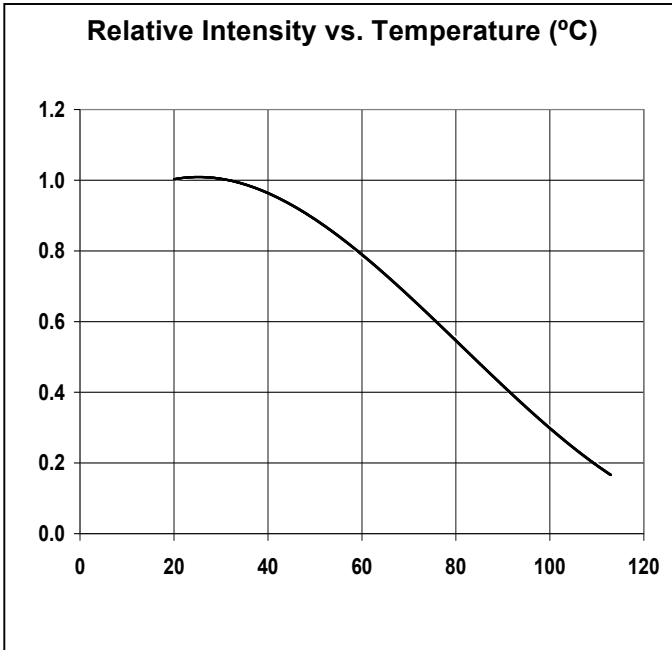

These are typical measurements, representative of specific production lots; actual curves may vary.